

**MODEL AO2053E**  
**SPEED INCREASER**

Model AO2053E is a heavy duty unit mounted speed increaser having engine rotation. It is available with a variety of input bell housings to fit the different engines. A wide range of ratios are offered. The gears are helical, carburized and are designed per AGMA specifications. The bearings are tapered roller. The case is cast iron.

CAPACITY:	450 lb. ft. (nominal input torque)
MAXIMUM INPUT SPEED:	3000 RPM
MAXIMUM OUTPUT SPEED:	4500 RPM
RATIOS: (STANDARD)	1.50, 1.96
(SPECIAL)	1.42, 1.67, 2.48, 3.0
BELL HOUSINGS:	SAE #1, #2, #3, #4
CLUTCH SIZES:	C110, SP111, SP211, SP114
OUTPUT SHAFT:	2.250 diameter x 5' long, 5/8 x 5/16 keyway. Output shaft located above the input shaft at 12 o'clock.
REAR SUPPORT:	4 Holes 1/2-13 on rear cover for customer support plate
LUBRICATION:	Splash ISO Grade 68, AGMA #2
WEIGHT:	415 lbs

07/31/03

# MODEL AO2053E

## SPEED INCREASER

BELLHSG SAE#	DIM A
#1	16.5
#2, #3, #4	14.62

OUTPUT CAN BE ORIENTED  
AT 6 OR 12 O'CLOCK POSITION

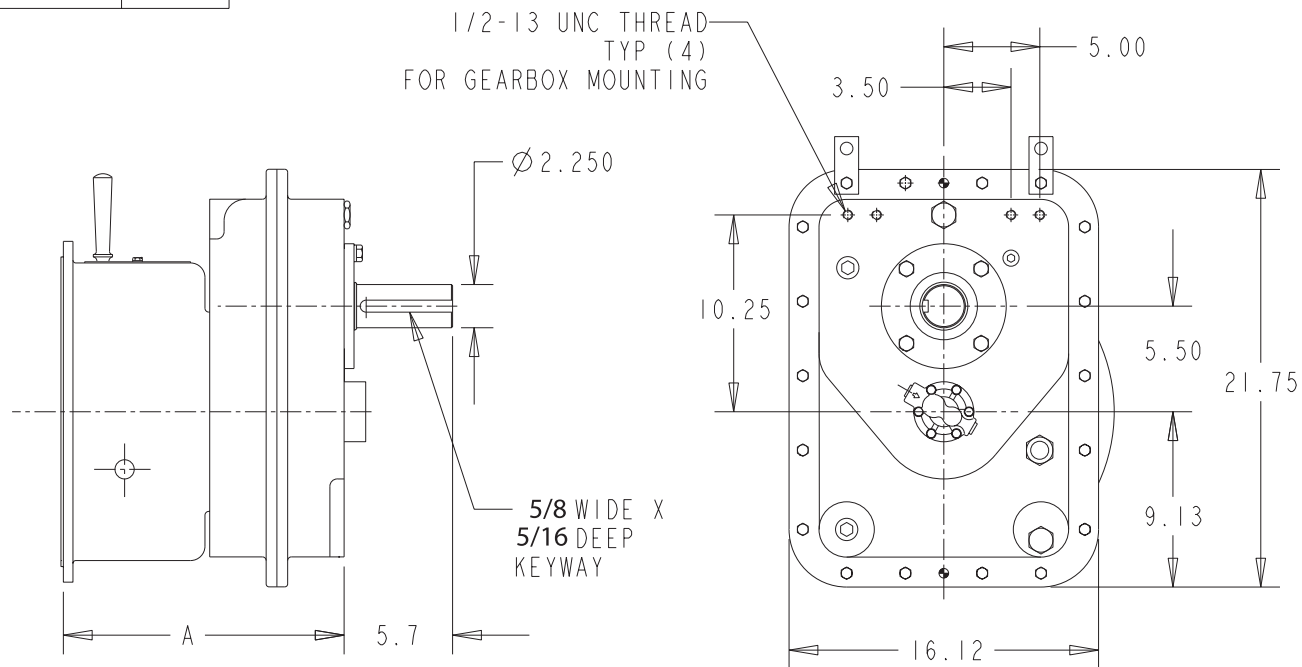

DO NOT USE DIMENSIONS ON THIS DRAWING FOR  
INSTALLATIONS, USE CERTIFIED PRINT PROVIDED  
WITH ORDERS.