



MODEL SN2105 HIGH SPEED GEARBOX

Product Description:

Model SN2105 is a single increasing stage, single output, foot mounted high-speed gearbox designed for test stand use. The gearbox is very compact and is suitable for table mount or enclosure into unitized test stands.

POWER:	200 HP nominal
OUTPUT SPEED:	18,000 rpm standard, 20,000 rpm by special design
RATIOS:	Up to 4.68 overspeed. For higher ratios contact Cotta.
MAX ACCEL / DECEL RATE:	2000 RPM / sec at output
INPUT CONFIGURATION:	Keyed stub shaft is standard. Contact Cotta for optional inputs.
OUTPUT CONFIGURATION:	Aerospace accessory mounting pad AND20002 typical. Various other shafting and mounting pads available.
ROTATION:	Input can be driven ccw or cw. Output rotates opposite to input.
LUBRICATION:	Gearbox requires lube support system similar to Cotta T-5.
OIL RESERVOIR:	Separate oil reservoir required.
OPTIONS:	Accelerometers, speed pickup, and other application specific items can be accommodated or supplied.
APPROXIMATE WEIGHT:	150 lbs.
STANDARD FINISH:	2-part polyurethane enamel



This drawing shows general arrangement and approximate space claim. Do not design, scale, or lay out using this drawing. Use only certified drawings provided by Cotta Engineering.

Optional enclosed speed pickup shown.

Aerospace accessory drive pad shown. Various other shaft and pad outputs are available.

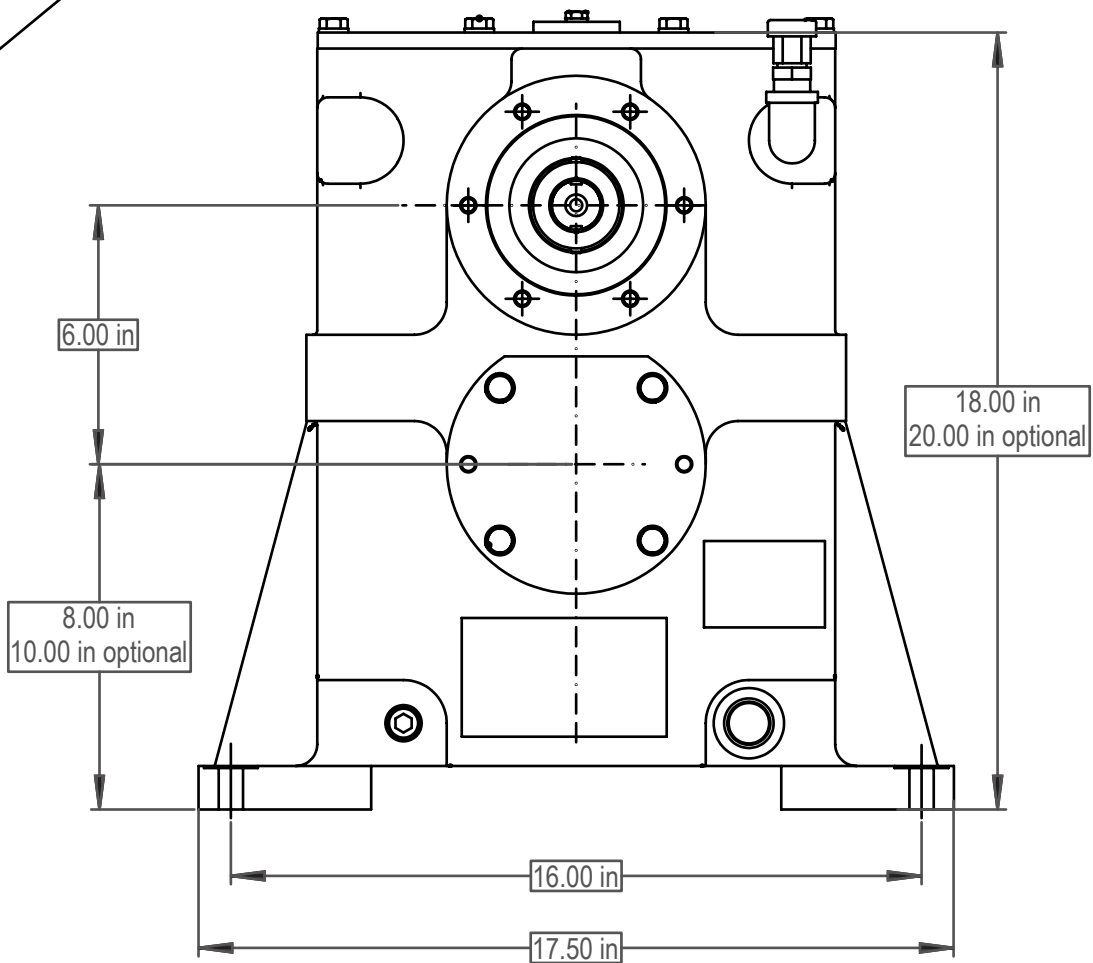
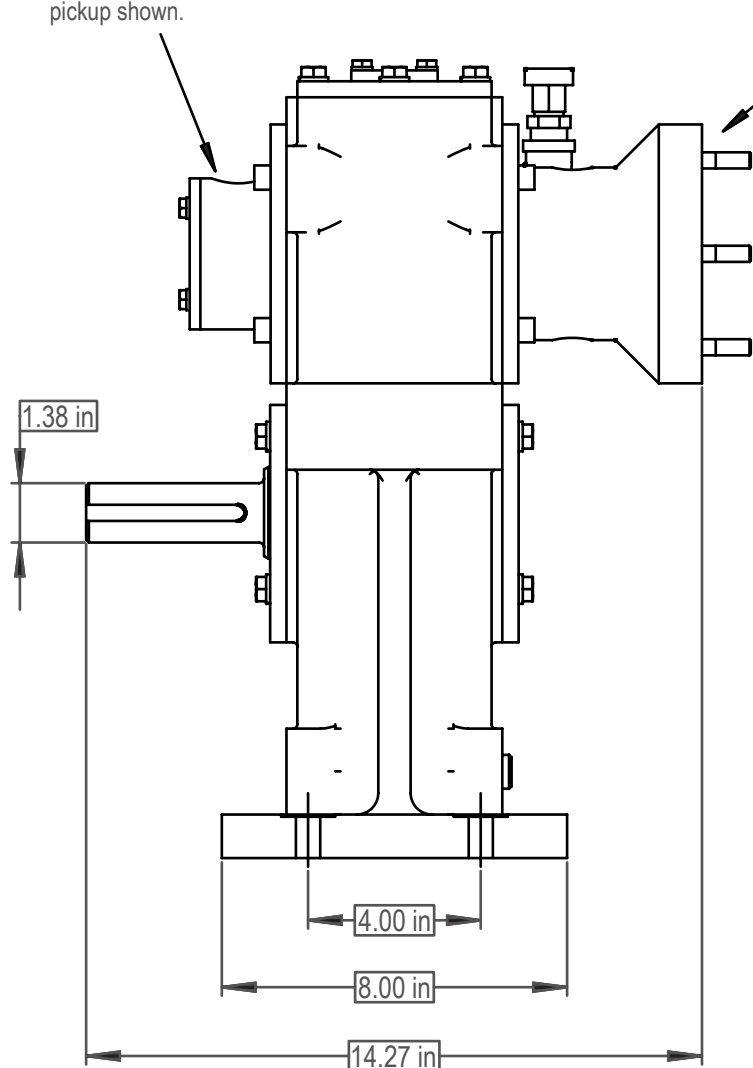

SN2105 DRW.