



MODEL TR2273 CREEP DRIVE GEARBOX

Product Description:

Model TR2273 is an auxiliary gearbox designed to provide precision vehicle speed control by using a hydraulic motor to rotate the vehicle drive shaft. The Creep Drive gearbox is installed in the drive-line between the main transmission and rear axle. In road mode power is transmitted normally via a through shaft in the gearbox. In creep mode the main transmission is shifted to neutral and the hydraulic motor and reduction gear-set in the gearbox are engaged to rotate the drive-line. Applications include paint-striper, feeders, spreaders, lifts, road/rail, and similar uses requiring precise speed control, inching, or remote operation.

NOMINAL APPLICATION POWER:	450 HP
MAX INPUT SPEED:	3000 RPM Drive shaft 500 RPM Motor pad.
TORQUE CAPACITY:	Drive shaft - 12,500 lb-ft. Motor pad - CC spline 900 lb-ft Motor pad - D spline 1250 lb-ft
REDUCTION RATIO:	3:1 gearbox 13.5:1 using optional 4.5:1 input planetary
MOTOR/PUMP PAD:	SAE "C" SAE "D" with optional planetary gearbox
THROUGH SHAFT SPLINE SIZE:	2.75 X 10 Straight side
MOUNTING:	(4) 3/4"-10 tapped holes on 11"X13" rectangular pattern
LUBRICATION:	Internal reservoir. Splash delivery
SHIFTING:	Dual acting air cylinder
WEIGHT:	Approximately 400 lbs.



This drawing shows general arrangement and approximate space claim. Do not design, scale, or lay out using this drawing. Use only certified drawings provided by Cotta Engineering.

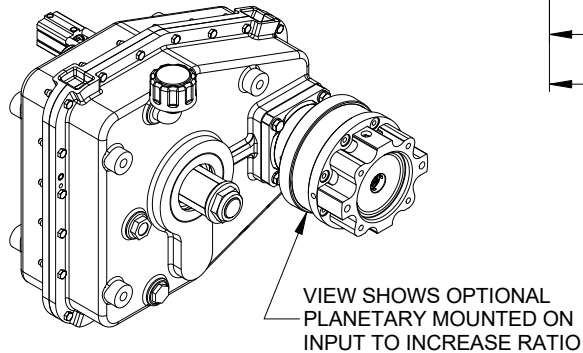
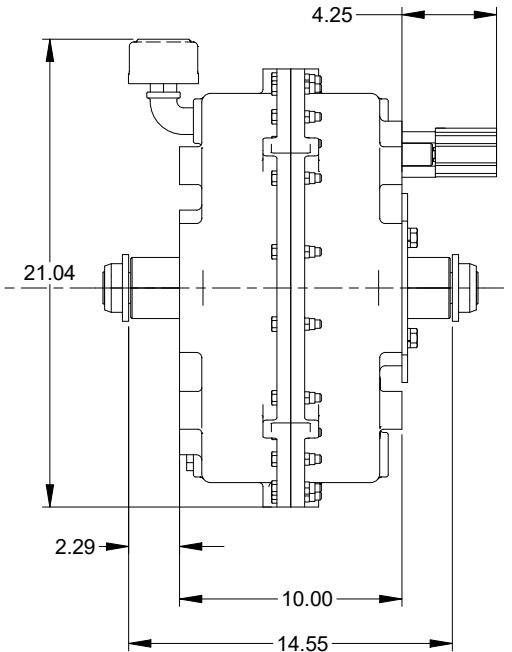
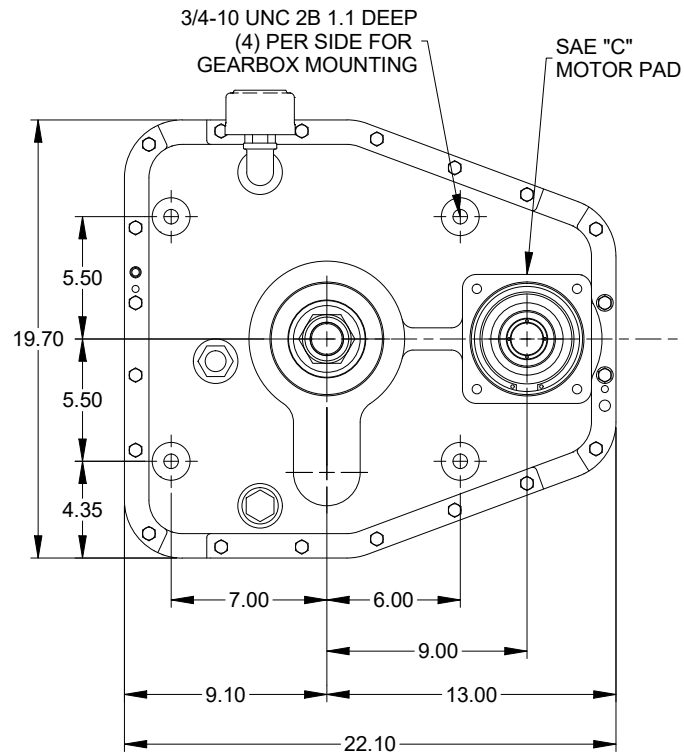
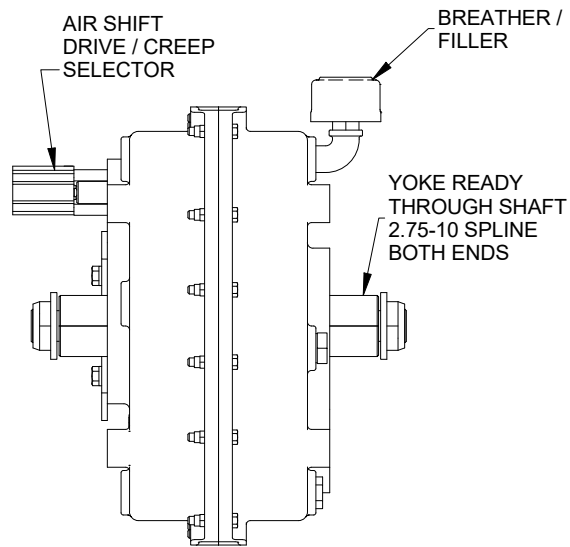

TR2273 DRW.